

ALUMINUM AND STAINLESS STEEL, 1:1 RATIO

Triton[®] 1:1 Spray Packages

309304S

EN

For high-performance, low pressure finishing and coating applications in hazardous or non-hazardous locations. For professional use only.

- Pail Mount Packages**
- Stand Mount Packages**
- Cart Mount Packages**
- Wall Mount Packages**

100 psi (0.7 MPa, 7 bar) Maximum Air Inlet Pressure

100 psi (0.7 MPa, 7 bar) Maximum Fluid Working Pressure

See page 3 for model information.



Important Safety Instructions

Read all warnings and instructions in this manual before using the equipment. Be familiar with the proper control and usage of the equipment. Save these instructions.

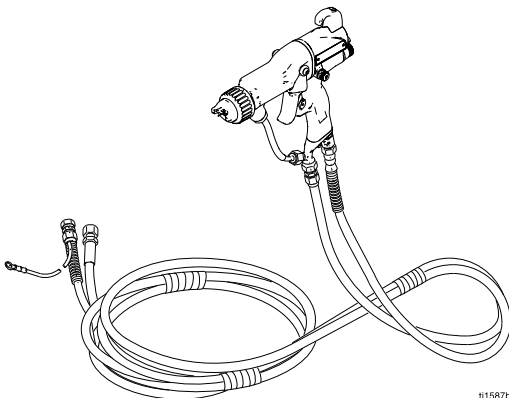

Electrostatic packages

t11587b

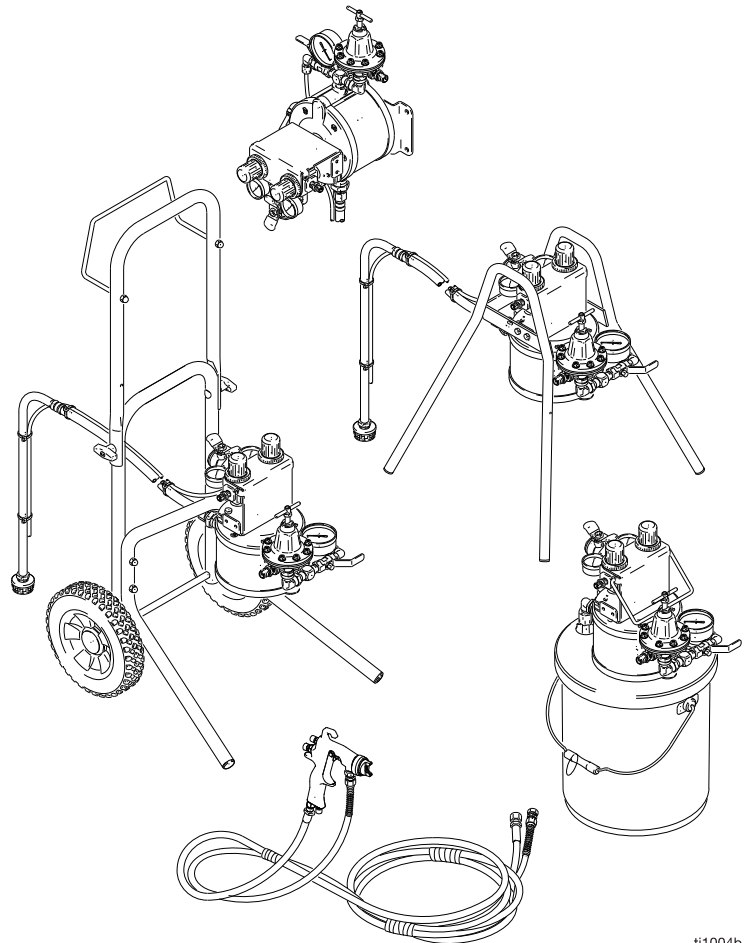

Air Spray packages and HVLP packages

t11004b

Contents

Contents 2

Related Manuals..... 2

Models..... 3

Safety Symbols..... 4

General Warnings..... 5

Component Identification 7

Installation..... 8

 General Information 8

 Prepare the Site 8

 Pump Outlet Fluid Filter Accessories..... 9

 Gun Inlet Filter 9

 Agitator Kit 245081 9

 Fluid Suction Line 9

 Preparing the Operator 9

 Wall Mount Packages 10

 Suction Kit Accessories 10

 Grounding 11

 Flush Before Using Equipment 11

 Pressure Relief Procedure 11

Maintenance 12

 Daily Maintenance 12

 Flushing the System 12

Recycling and Disposal 12

 End of Product Life 12

Troubleshooting 13

Parts 14

Technical Specifications 27

Wall Mounting Template 29



Graco Standard Warranty 30

Related Manuals

Find English manuals and any available translations at www.graco.com.

English Manual Number	Description
309305	TRITON™ 1:1 Spray Package, Operation
309303	TRITON™ 1:1 Diaphragm Pump, Instructions-Parts
3A2494	Pro XP™ Electrostatic Air Spray Gun, Instructions-Parts
308325	Acetal Fluid Pressure Regulators, Instructions
307212	Stainless Steel Fluid Pressure Regulators, Instructions-Parts
309306	Stainless Steel Agitator Kit, Instructions-Parts
3B0141	Stellair Air Spray Gun, Instructions





Models

Spray Package Description	Pail Mount, Series	Stand Mount, Series	Cart Mount, Series	Wall Mount, Series	Approvals	
					UK CA	 
Aluminum Pump, No Gun	233466, A	233473, A	233480, A	233487, A	✓	✓
Stainless Steel Pump, No Gun	233467, A	233474, A	233481, A	233488, A	✓	✓
Aluminum Pump, Stellair Conventional Gun	233468, D	233475, D	233482, D	233489, D		✓
Stainless Steel Pump, Stellair Conventional Gun	233469, D	233476, D	233483, D	233490, D		✓
Aluminum Pump, Stellair HVLP Spray Gun	233470, D	233477, D	233484, D	233491, D		✓
Stainless Steel Pump, Stellair HVLP Spray Gun	233471, D	233478, D	233485, D	233492, D		✓
Aluminum Pump, Stellair Compliant Gun	234911, C	234913, C	234915, C	234917, C		✓
Stainless Steel Pump, Stellair Compliant Gun	234912, C	234914, C	234916, C	234918, C		✓
Aluminum Pump, Pro XP 40 Electrostatic Spray Gun	233741, B	233743, B	233746, B	233748, B	✓	✓
Aluminum Pump, Pro XP 60 Electrostatic Spray Gun	233742, B	233744, B	233747, B	233749, B	✓	✓
Aluminum Pump, Pro XP 85 Electrostatic Spray Gun	289648, B	289649, B	289641, B	289631, B	✓	✓

Safety Symbols

The following safety symbols appear throughout this manual and on warning labels. Read the table below to understand what each symbol means.

Symbol	Meaning
	Equipment Misuse Hazard
	Fire and Explosion Hazard
	Pressurized Equipment Hazard
	Splash Hazard
	Toxic Fluid or Fumes Hazard
	Eliminate Ignition Sources

Symbol	Meaning
	Follow Pressure Relief Procedure
	Ground Equipment
	Read Safety Data Sheet
	Ventilate Work Area
	Wear Personal Protective Equipment











Safety Alert Symbol





This symbol indicates: Attention! Become Alert! Look for this symbol throughout the manual to indicate important safety messages.

General Warnings

The following warnings apply throughout this manual. Read, understand, and follow the warnings before using this equipment. Failure to follow these warnings can result in serious injury.

 WARNING	
  	<p>PRESSURIZED EQUIPMENT HAZARD</p> <p>Fluid from the equipment, leaks, or ruptured components can splash in the eyes or on skin and cause serious injury.</p> <ul style="list-style-type: none"> • Follow the Pressure Relief Procedure when you stop spraying/dispensing and before cleaning, checking, or servicing equipment. • Tighten all fluid connections before operating the equipment. • Check hoses, tubes, and couplings daily. Replace worn or damaged parts immediately.
   	<p>FIRE AND EXPLOSION HAZARD</p> <p>Flammable fumes, such as solvent and paint fumes, in work area can ignite or explode. Paint or solvent flowing through the equipment can cause static sparking. To help prevent fire and explosion:</p> <ul style="list-style-type: none"> • Electrostatic equipment must be used only by trained, qualified personnel who understand the requirements of this manual. • Ground all equipment, personnel, object being sprayed, and conductive objects in or close to spray area. Resistance must not exceed 1 megohm. See Grounding instructions. • Electrostatic guns require special grounding procedures. If your package includes an electrostatic spray gun, read and follow all grounding instructions in the gun manual 3A2494. • Only use grounded Graco conductive air supply hoses. • Do not use pail liners unless they are conductive and grounded. • Stop operation immediately if static sparking occurs or you feel a shock. Do not use equipment until you identify and correct the problem. • Check gun resistance, hose resistance, and electrical grounding daily. • Use and clean equipment only in well-ventilated area. • Use cleaning solvents with highest possible flash point when flushing or cleaning equipment. • Never spray or flush solvent at high pressure. • Always turn the electrostatics off when flushing, cleaning or servicing equipment. • Eliminate all ignition sources, such as pilot lights, cigarettes, portable electric lamps, and plastic drop cloths (potential static sparking). • Do not plug or unplug power cords or turn lights on or off when flammable fumes are present. • Keep work area free of debris, including solvent, rags and gasoline. • Keep a working fire extinguisher in the work area.
	<p>TOXIC FLUID OR FUMES HAZARD</p> <p>Toxic fluids or fumes can cause serious injury or death if splashed in the eyes or on skin, inhaled, or swallowed.</p> <ul style="list-style-type: none"> • Read Safety Data Sheets (SDSs) to know the specific hazards of the fluids you are using. • Route exhaust away from work area. If diaphragm ruptures, fluid may be exhausted into the air. • Store hazardous fluid in approved containers, and dispose of it according to applicable guidelines.

! WARNING

 	<p>EQUIPMENT MISUSE HAZARD Misuse can cause death or serious injury.</p> <ul style="list-style-type: none"> • Do not operate the unit when fatigued or under the influence of drugs or alcohol. • Do not exceed the maximum working pressure or temperature rating of the lowest rated system component. See Technical Specifications in all equipment manuals. • Use fluids and solvents that are compatible with equipment wetted parts. See Technical Specifications in all equipment manuals. Read fluid and solvent manufacturer’s warnings. For complete information about your material, request Safety Data Sheets (SDSs) from distributor or retailer. • Turn off all equipment and follow the Pressure Relief Procedure when equipment is not in use. • Check equipment daily. Repair or replace worn or damaged parts immediately with genuine manufacturer’s replacement parts only. • Do not alter or modify equipment. Alterations or modifications may void agency approvals and create safety hazards. • Make sure all equipment is rated and approved for the environment in which you are using it. • Use equipment only for its intended purpose. Call your distributor for information. • Route hoses and cables away from traffic areas, sharp edges, moving parts, and hot surfaces. • Do not kink or over bend hoses or use hoses to pull equipment. • Keep children and animals away from work area. • Comply with all applicable safety regulations.
	<p>PRESSURIZED ALUMINUM PARTS HAZARD Use of fluids that are incompatible with aluminum in pressurized equipment can cause serious chemical reaction and equipment rupture. Failure to follow this warning can result in death, serious injury, or property damage.</p> <ul style="list-style-type: none"> • Do not use 1,1,1-trichloroethane, methylene chloride, other halogenated hydrocarbon solvents or fluids containing such solvents. • Do not use chlorine bleach. • Many other fluids may contain chemicals that can react with aluminum. Contact your material supplier for compatibility.
	<p>PERSONAL PROTECTIVE EQUIPMENT Wear appropriate protective equipment when in the work area to help prevent serious injury, including eye injury, hearing loss, inhalation of toxic fumes, and burns. Protective equipment includes but is not limited to:</p> <ul style="list-style-type: none"> • Protective eyewear, and hearing protection. • Respirators, protective clothing, and gloves as recommended by the fluid and solvent manufacturer.

Component Identification

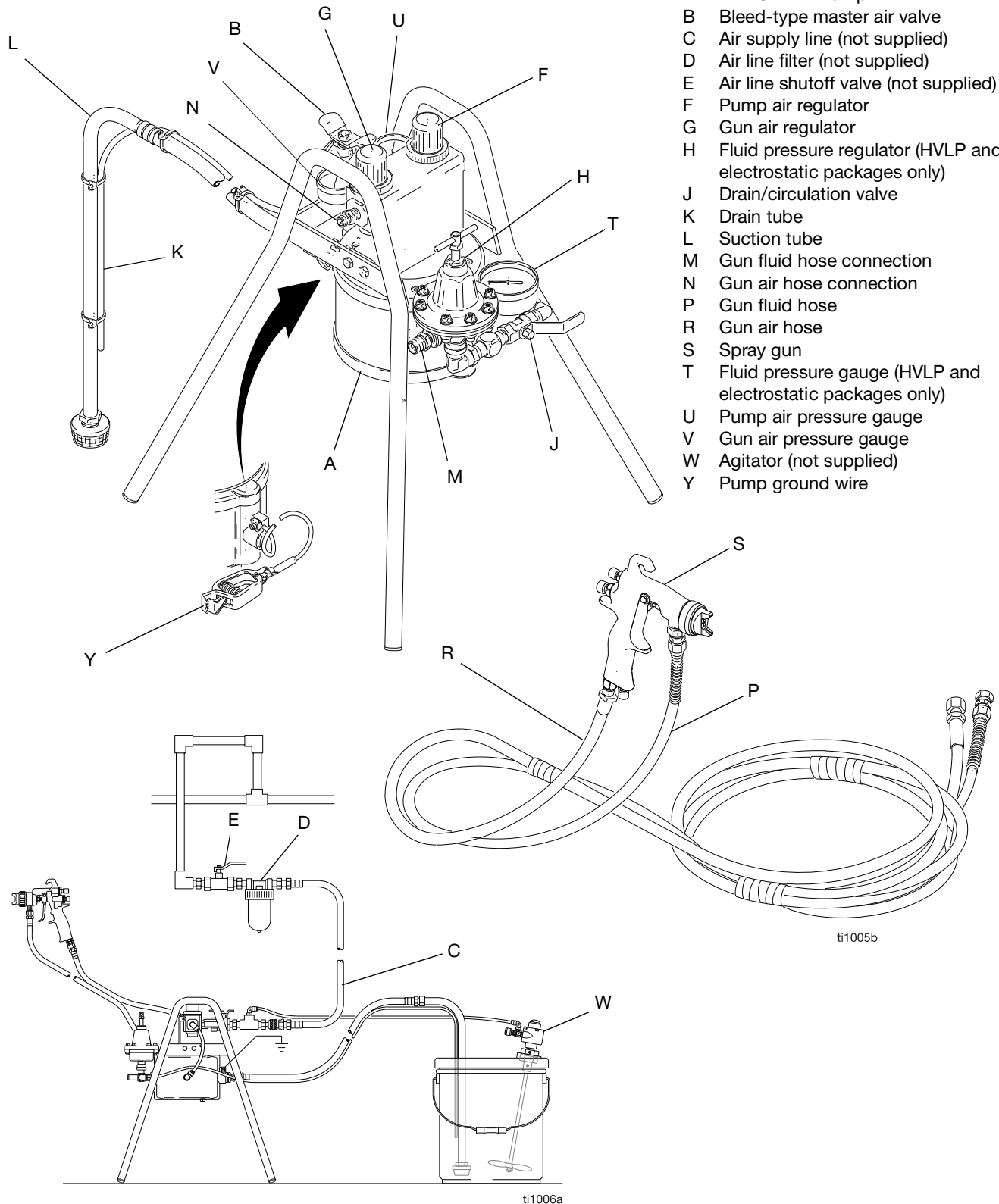

Key:

- A TRITON 1:1 Pump
- B Bleed-type master air valve
- C Air supply line (not supplied)
- D Air line filter (not supplied)
- E Air line shutoff valve (not supplied)
- F Pump air regulator
- G Gun air regulator
- H Fluid pressure regulator (HVLV and electrostatic packages only)
- J Drain/circulation valve
- K Drain tube
- L Suction tube
- M Gun fluid hose connection
- N Gun air hose connection
- P Gun fluid hose
- R Gun air hose
- S Spray gun
- T Fluid pressure gauge (HVLV and electrostatic packages only)
- U Pump air pressure gauge
- V Gun air pressure gauge
- W Agitator (not supplied)
- Y Pump ground wire



Installation

NOTICE				
<p>Use a stainless steel package to spray waterborne, acid-catalyzed, or 2-component materials. Use of aluminum packages with these materials is not recommended. See the wetted parts in the Technical Data section of each component manual, and your fluid and solvent manufacturer's compatibility information.</p>				

				
<p>Hazardous fluid or toxic fumes can cause serious injury or death if splashed in the eyes or on the skin, inhaled, or swallowed.</p> <p>Use fluids and solvents that are compatible with the equipment wetted parts. Refer to the Technical Data section of all equipment manuals. Read the fluid and solvent manufacturer's warnings.</p>				

General Information

Always use Genuine Graco Parts and Accessories, available from your Graco distributor. If you supply your own accessories, be sure they are adequately sized and pressure rated for your system.

Reference numbers and letters in parentheses refer to the callouts in the Figs. and the **Parts** lists starting on page 14.

Prepare the Site

				
<p>To prevent hazardous concentrations of toxic and/or flammable vapors, spray only in a properly ventilated spray booth. Never operate the spray gun unless ventilation fans are operating.</p> <p>Check and follow all of the national, state, and local codes regarding air exhaust velocity requirements.</p>				

Ensure that you have an adequate compressed air supply for the pump and gun. Refer to the separate pump and gun manuals for air consumption data. See **Related Manuals**, page 2.

Clear obstacles and debris that could cause an unsafe operating environment.

Have a grounded, metal pail available for use when flushing the spray package.

Bring an air supply line (C) from the main air supply to the pump location. Install an accessory air filter (D) on the compressed air line to filter dirt and moisture from the air supply. Install a shutoff valve (E) to isolate the filter for cleaning.

When the bleed-type master air valve (B) is closed and the pump air regulator (F) and gun air regulator (G) are opened, it relieves all air pressure to the system components.

Ventilate the spray booth.

Pump Outlet Fluid Filter Accessories

To install a fluid filter on the pump outlet, order a filter (AA), swivel (BB), and nipple (CC). Refer to Table 1: for the part numbers you must order for an aluminum or a stainless steel package.

Refer to FIG. 1. Install the fluid filter between the pump fluid outlet and the gun fluid hose connection. If a fluid regulator (H) is present, it must be rotated so the gauge (T) will clear the filter.

Table 1: Install Fluid Filter

Fluid Filter (AA)	Swivel (BB)	Nipple (CC)
114361; nylon; 150 psi; 80 mesh; for aluminum or stainless steel packages	235207; 3/8 npt(m) x 3/8 npsm(f); sst	166863; 1/4 npt x 3/8 npt; sst
157705; 1/4 npt(m) x 3/8 npsm(f); cst	157705; 1/4 npt(m) x 3/8 npsm(f); cst	165198; 1/4 npt x 3/8 npt; cst
223160; sst; 5000 psi; 60 mesh; for stainless steel packages	235207; 3/8 npt(m) x 3/8 npsm(f); sst	166863; 1/4 npt x 3/8 npt; sst

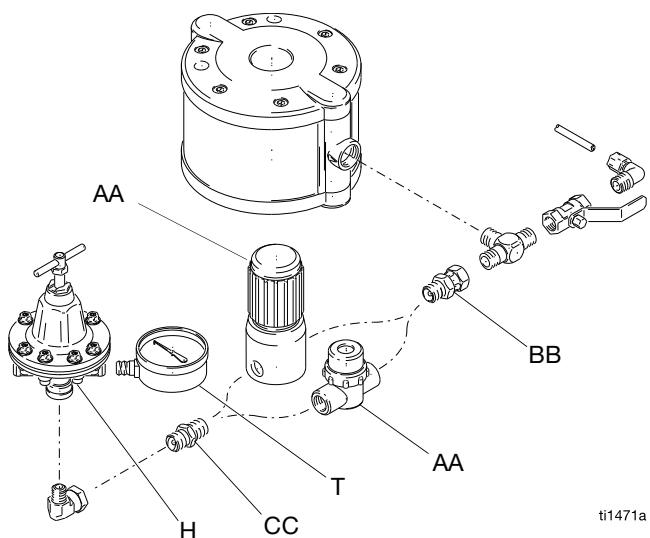

FIG. 1

Gun Inlet Filter

To install a filter between the hose and gun inlet, order Filter 915921, 100 mesh, 500 psi, sst, 3/8 npsm (m x f).

Agitator Kit 245081

Part No. 245081 Agitator Kit is available for the TRITON Sprayer Packages as an accessory. The kit must be ordered separately. Instructions are included.

Fluid Suction Line

The pump fluid inlet is 3/4 npt(f). Screw the suction line (L) into the pump inlet snugly. Use a compatible liquid thread sealant on connections to prevent air from getting into the fluid line.

Do not pressure feed this pump.

See the **Technical Data** in the pump manual 309303 for maximum suction lift.

Preparing the Operator

Anybody who operates this system should be trained in the safe, efficient operation of all system components. At a minimum, all operators should thoroughly read the TRITON operation manual, 309305.

Wall Mount Packages

NOTE: See FIG. 2 and the **Wall Mounting Template** on page 29.

1. Ensure that the wall is strong enough to support the weight of the pump and accessories, fluid, hoses, and stress caused during pump operation.
2. Use the **Wall Mounting Template** on page 29 to set the position of the wall bracket. The top edge of the bracket should be 4 to 5 ft (1.2 to 1.5 m) above the floor. Verify that the dimensions are exact and the hole locations are level before drilling the holes.

NOTE: It is easier to mount the wall bracket (31) if the control bracket (4) and pump (1) are removed. Disconnect the air tube (12) from the elbow (11), then loosen the two screws (3) and lift the control bracket (4) off the screws. To remove the pump (1), remove the screws (3) entirely.

3. Using the template, drill four 0.38 in. (9.6 mm) diameter holes in the wall. Attach the bracket with anchors and screws that are long enough to keep the bracket from vibrating during operation. Check that the bracket is level.

Suction Kit Accessories

Suction kits are available for the wall mount packages, as an accessory. The kits must be ordered separately. Refer to Table 2: for information.

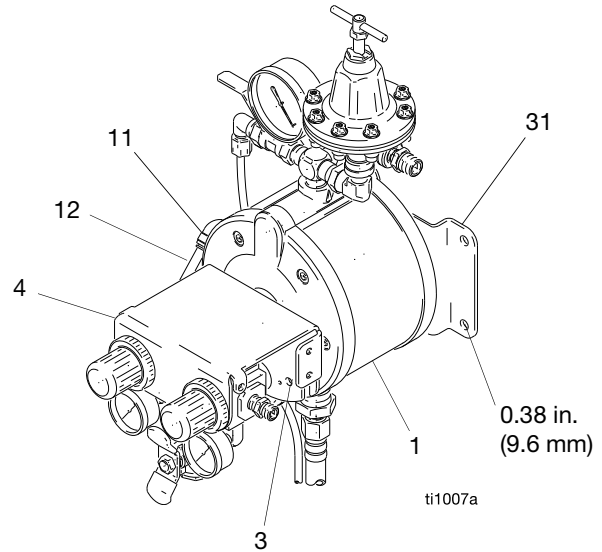





FIG. 2

Table 2: Wall Mount Suction Kits

Part No.	Suction Kit Description	Hose Length	Tube Length
245082	Aluminum, 5 gal pail size, with strainer	4 ft (1.2 m)	17 in. (0.43 m)
245083	Stainless Steel, 5 gal pail size, with strainer	4 ft (1.2 m)	17 in. (0.43 m)
245084	Aluminum, 55 gal drum size, with bung adapter	6 ft (1.8 m)	38 in. (0.96 m)
245085	Stainless Steel, 55 gal drum size, with bung adapter	6 ft (1.8 m)	38 in. (0.96 m)

Grounding

				
<p>The equipment must be grounded to reduce the risk of static sparking. Static sparking can cause fumes to ignite or explode. Grounding provides an escape wire for the electric current.</p>				

Spray package: one end of the ground wire is already connected to the pump. Connect the clamp end of the ground wire to a true earth ground.

Packages with Pro Xp electrostatic guns: make sure you read all of the grounding instructions and warnings in your gun instruction manual 3A2494.

Air compressor: follow manufacturer’s recommendations.

Fluid supply container: follow local codes and regulations.

Object being sprayed: follow local codes and regulations.

Solvent pails used when flushing: follow local code. Use only conductive metal pails, placed on a grounded surface. Do not place the pail on a nonconductive surface, such as paper or cardboard, which interrupts grounding continuity.







To maintain grounding continuity when flushing or relieving pressure: hold metal part of the spray gun/dispense valve firmly to the side of a grounded metal pail, then trigger the gun/valve.

Flush Before Using Equipment

The equipment was tested with lightweight oil, which is left in the fluid passages to protect parts. To avoid contaminating your fluid with oil, flush the equipment with a compatible solvent before using the equipment. See **Flushing the System**, page 12.

Pressure Relief Procedure

 Follow the Pressure Relief Procedure whenever you see this symbol.

				
				
<p>This equipment stays pressurized until pressure is manually relieved. To help prevent serious injury from pressurized fluid, such as skin injection, splashing fluid and moving parts, follow the Pressure Relief Procedure when you stop spraying and before cleaning, checking, or servicing the equipment.</p>				

1. Close the bleed-type master air valve (B) to relieve the air pressure.
2. **On electrostatic guns only**, turn the ES ON/OFF lever to OFF.
3. Hold a metal part of the gun (S) firmly to a grounded metal pail. Trigger the gun to relieve the fluid pressure.
4. Place the drain tube (K) in a waste pail. Open the drain/circulation valve (J) to relieve any fluid pressure trapped in the system.
5. If you suspect the spray tip or hose is clogged or that pressure has not been fully relieved:
 - a. **VERY SLOWLY** loosen the tip guard retaining nut or the hose end coupling to relieve pressure gradually.
 - b. Loosen the nut or the coupling completely.
 - c. Clear the obstruction in the hose or tip.

Maintenance

See the separate component instruction manuals for individual component maintenance procedures. See **Related Manuals**, page 2.

Daily Maintenance

Check the hoses, tubes, and couplings daily. Tighten all fluid connections before each use.

Flushing the System

Flush the system at the following times:

- Before the first-time use
- When changing colors
- Before fluid can dry or settle out in a dormant system
- Before storing the system

Recycling and Disposal

End of Product Life

At the end of the product's useful life, dismantle and recycle it in a responsible manner.

- Perform the **Pressure Relief Procedure**.
- Drain and dispose of fluids according to applicable regulations. Refer to the material manufacturer's Safety Data Sheet.
- Deliver remaining product to a recycling facility.

Troubleshooting

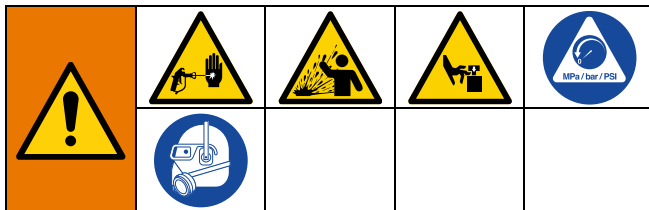

1. Follow **Pressure Relief Procedure**, page 11, before checking or repairing the equipment.
2. Check all possible problems and causes before disassembling the equipment.

Problem	Cause	Solution
Pump will not run.	Closed air line valve.	Open valve.
	Inadequate air supply, or clogged/ restricted air line.	Increase air supply. Do not exceed maximum air inlet pressure.
		Open or clear air line.
		Clean air filter.
	Clogged fluid line or spray gun.	Clear, service. Do not allow fluid to set up in the pump and lines.
	Stuck or damaged pump air valve.	Service pump. Use filtered air.
Ruptured diaphragm.	Service pump.	
Pump runs sluggishly.	Worn or damaged spool o-rings.	Service pump.
Pump runs erratically.	Clogged suction line or inlet strainer.	Clear.
	Sticking or leaking check valves.	Service pump.
Pump runs too fast.	Exhausted fluid supply.	Refill fluid supply and prime sprayer.
Pump cycles at stall or fails to hold pressure at stall.	Worn check valves or o-rings.	Service pump.
Audible air leak.	Worn air valve cup or plate.	Service pump.
Air bubbles in fluid.	Loose suction line.	Tighten. Use a compatible liquid thread sealant on connections.
Poor finish or irregular spray pattern.	Incorrect fluid or air pressure at gun.	See gun manual; read fluid manufacturer's recommendations.
		Use fluid regulator.
	Fluid is too thin or too thick.	Adjust fluid viscosity; read fluid manufacturer's recommendations.
	Dirty, worn, or damaged spray gun.	Service gun.
Fluid is settling out.	Use agitator. Order Part No. 245081 Agitator Kit.	

Parts

Pail Mount Packages (see Models, page 3)

Models 233466, 233467, 233468, 233469, 233470, 233471, 234911, 234912, 233741, 233742, 289642, 289643, 289644, 289645, 289646, 289647, 289648, and 2006381

△ Items 56–59 are used on Models 233470, 233471, 233741, 233742, 234911, 234912, 289642, 289643, 289645, 289646, and 289648 only.

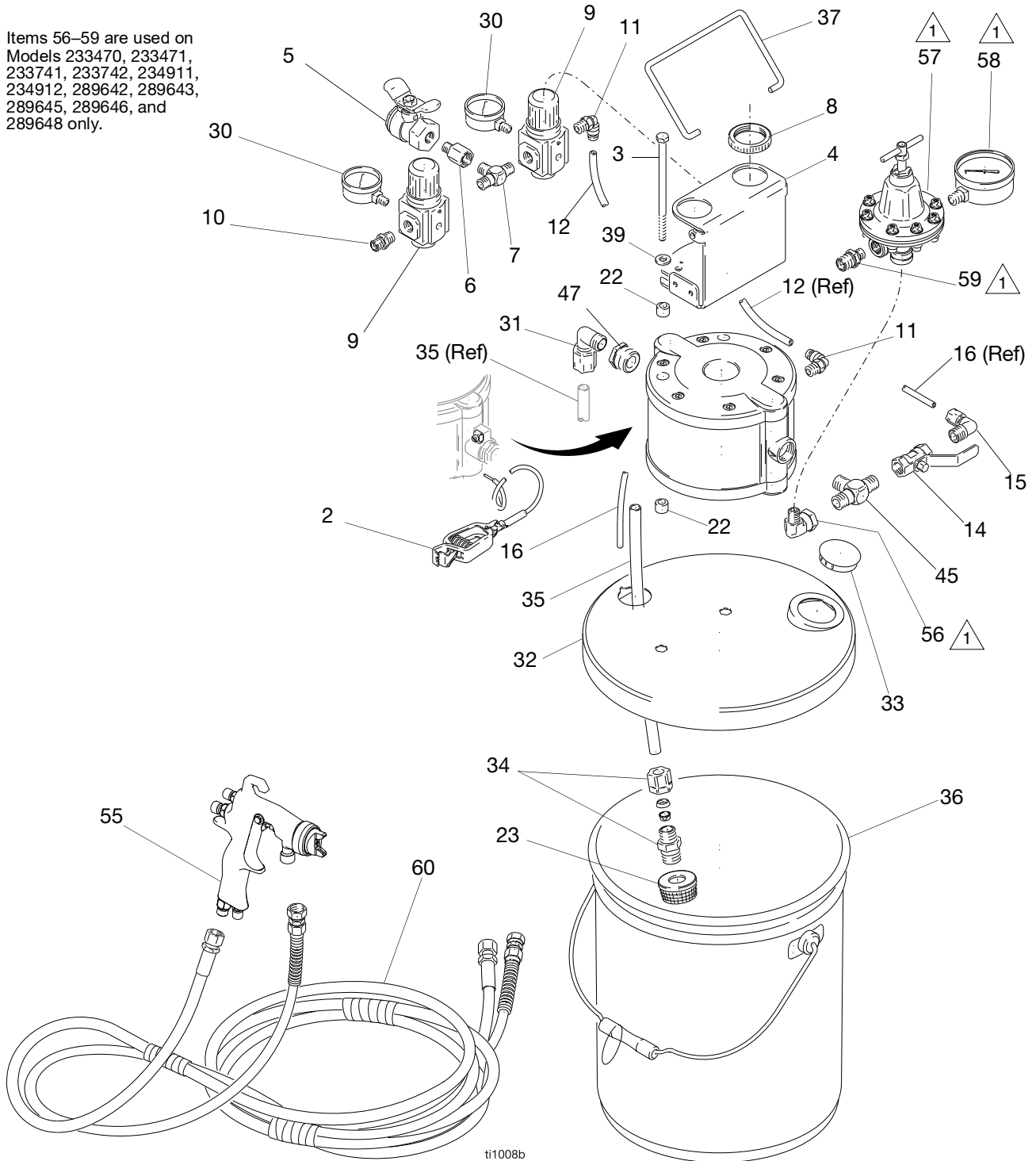

ti1008b

Pail Mount Packages

Ref.	Part	Description	Qty	Ref.	Part	Description	Qty
1	233500	PUMP, diaphragm; aluminum; <i>for 233466, 233468, 233470, 233741, 233742</i>	1	47	116350	BUSHING; sst; 3/4 npt(m) x 3/8 npt(f)	1
	233501	PUMP, diaphragm; sst; <i>for 233467, 233469, 233471, and 2006381</i>	1	55	2004145	GUN, Stellair Conventional; <i>for 233468, 233469; see manual 3B0141</i>	1
2	238909	GROUND WIRE & CLAMP ASSY	1	2004152	GUN, Stellair HVLP spray; <i>for 233470, 233471; see manual 3B0141</i>	1	
3	116311	SCREW, cap, hex hd; 5/16 unc x 5.5 in. (140 mm)	2	2004155	GUN, Stellair Compliant spray; <i>for 234911, 234912; see manual 3B0141</i>	1	
4	197126	BRACKET, control	1	2005972	GUN, Stellair Compliant inlet air; <i>for 2006381; see manual 3B0141</i>	1	
5	116473	VALVE, air, bleed-type; 1/4 npt(fbe)	1	L40T10	GUN, Pro Xp 40 electrostatic; <i>for 233741</i>	1	
6	116393	ADAPTER; 1/4 npt (m x f)	1	L60T10	GUN, Pro Xp 60 electrostatic; <i>for 233742</i>	1	
7	115219	TEE; 1/4 npt(m)	1	L85T10	GUN, Pro Xp 85 electrostatic; <i>for 289648</i>	1	
8	116514	NUT, regulator	2	56	116395	ELBOW; cst; 1/4 npt(m) x 3/8 npt(f) swivel; <i>for 233470, 233741, 233742</i>	1
9	116513	REGULATOR, air	2	207123	ELBOW; sst; 3/8 npt(m) x 3/8 npsm(f) swivel; <i>for 233471</i>	1	
10	162453	NIPPLE; 1/4 npsm x 1/4 npt	1	57	241976	REGULATOR, fluid; acetal; 0–30 psi (0–0.2 MPa, 0–2 bar) range; includes gauge; <i>for 233470, 233741, 233742; see manual 308325</i>	1
11	115948	ELBOW; 1/4 npt(m) x 0.312 in. (8 mm) OD tubing	2	214895	REGULATOR, fluid; sst 0–100 psi (0–0.6 MPa, 0–7 bar) range; <i>for 233471; see manual 307212</i>	1	
12	buy locally	TUBE; polyethylene; 0.312 in. (8 mm) OD	0.5 ft	58	187874	GAUGE, pressure, fluid; sst; <i>for 233471</i>	1
14	114363	VALVE, ball, fluid; sst; 3/8 npt(fbe)	1				
15	116314	ELBOW; 3/8 npt(m) x 0.25 in. (6 mm) OD tubing	1				
16	buy locally	TUBE; polyethylene; 0.25 in. (6 mm) OD	2.2 ft				
22	197449	SPACER	4				
23	218798	STRAINER	1				
30	110436	GAUGE, pressure, air	2				
31	116315	ELBOW; 3/8 npt(m) x 0.5 in. (13 mm) OD tubing	1				
32	197298	COVER, pail; cst; <i>for 233466, 233468, 233470, 233741, 233742</i>	1				
	197216	COVER, pail; sst; <i>for 233467, 233469, 233471, 2006381</i>	1				
33	111813	PLUG, button	1				
34	116316	FITTING, straight; 1/2 npt(m) x 0.5 in. (13 mm) OD tubing	1				
35	197971	TUBE, suction; polyethylene; 0.5 in. (13 mm) OD x 14.5 in. (368 mm)	1				
36	101108	PAIL, 5 gal. (19 l); steel	1				
37	197127	HANDLE, pail mount	1				
39	104034	WASHER; 5/16 size	2				
45	113786	TEE; cst; 3/8 npt(m); <i>for 233466, 233468, 233470, 233741, 233742</i>	1				
	116400	TEE; sst; 3/8 npt(m); <i>for 233467, 233469, 233471, 2006381</i>	1				

Parts

Ref.	Part	Description	Qty
59	165198	NIPPLE; cst; 1/4 npt x 3/8 npt; <i>for 233470, 233741, 233742</i>	1
	171195	NIPPLE; sst; 3/8 npsm x 3/8 npt; <i>for 233471</i>	1
60	233499	HOSE ASSY; sst fittings; 3/8 npsm(f) nylon fluid hose; 1/4 npsm(f) air hose; 25 ft (7.6 m); <i>for 289642, 289643, 289644, 289645, 289646, 289647</i>	1
	240425	HOSE ASSY, electrostatic; 3/8 npsm(f) nylon fluid hose; 1/4 npsm(f) air hose with ground wire and left-hand thread; 25 ft (7.6 m); <i>for 233741, 233742, 289648</i>	1
	2006234	HOSE ASSY, NO-QC; 3/8 npsm(f) LLDPE fluid hose; 1/4 npsm(f) air hose; 25 ft (7.6 m); <i>for 233468, 233469, 233470, 233471, 234911, 234912</i>	1
	2006235	HOSE ASSY, QC; 3/8 npsm(f) x 1/8 npsm(f) LL DPE fluid hose; 1/4 npsm(f) air hose; 25 ft (11.6 m); <i>for 2006381</i>	1

Stand Mount Packages (see Models, page 3)

Models 233473, 233474, 233475, 233476, 233477, 233478, 234913, 234914, 233743, 233744, 289649, and 2006382

1 Items 56–59 are used on Models 233477, 233478, 233743, 233744, 234913, 234914, and 289649 only.

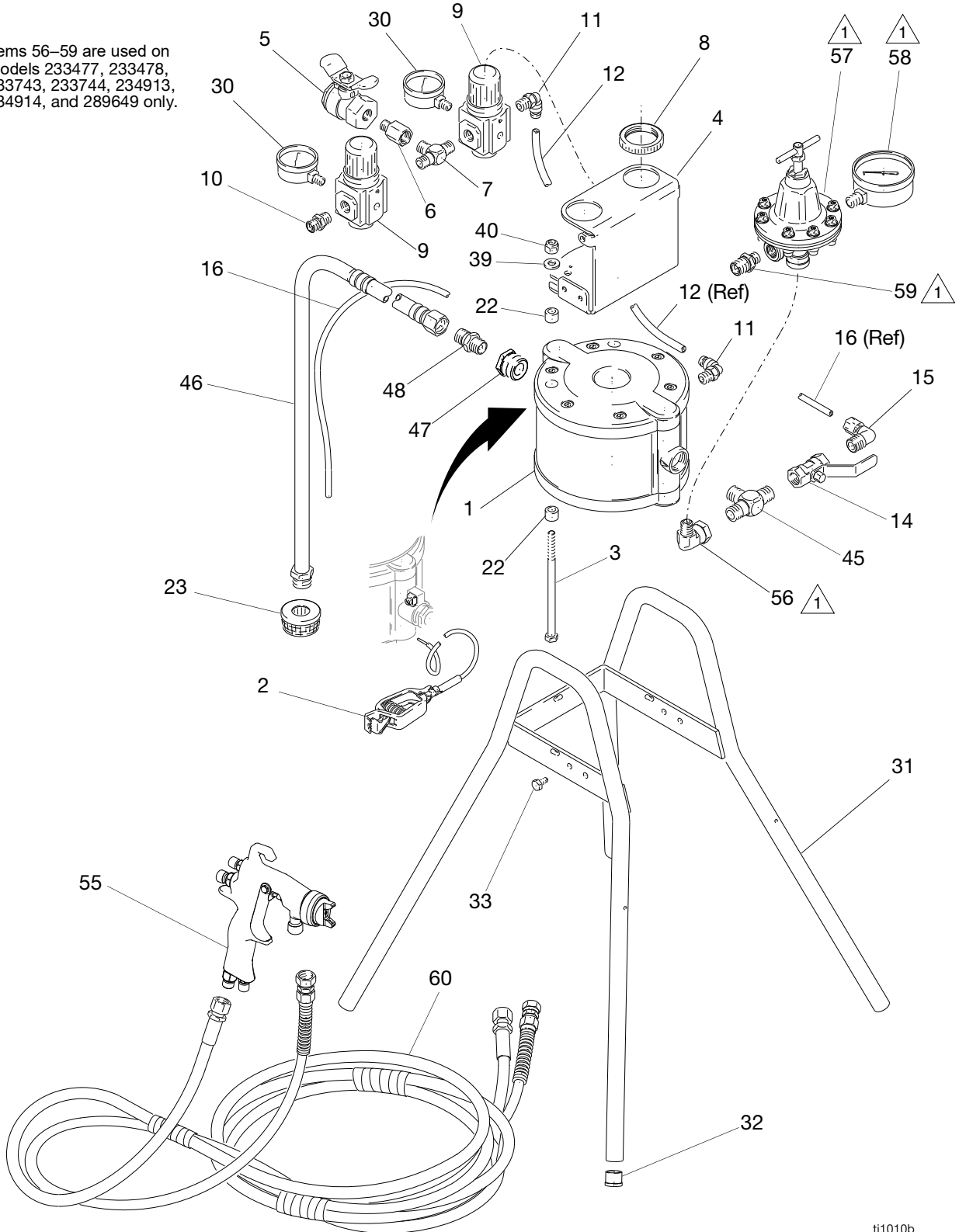

ti1010b

Stand Mount Packages

Ref.	Part	Description	Qty	Ref.	Part	Description	Qty
1	233500	PUMP, diaphragm; aluminum; for 233473, 233475, 233477, 233743, 233744	1	48	162485	NIPPLE; cst; 3/8 npsm x 3/8 npt; for 233473, 233475, 233477, 233743, 233744	1
	233501	PUMP, diaphragm; sst; for 233474, 233476, 233478, and 2006382	1		112100	NIPPLE; sst; 9/16–18 x 3/8 npt; for 233474, 233476, 233478, 2006382	1
2	238909	GROUND WIRE & CLAMP ASSY	1	55	2004145	GUN, Stellair Conventional; for 233475, 233476; see manual 3B0141	1
3	116311	SCREW, cap, hex hd; 5/16 unc x 5.5 in. (140 mm)	2		2004152	GUN, Stellair HVLP spray; for 233477, 233478; see manual 3B0141	1
4	197126	BRACKET, control	1		2004155	GUN, Stellair Compliant spray; for 234913, 234914; see manual 3B0141	1
5	116473	VALVE, air, bleed-type; 1/4 npt(fbe)	1		2005972	GUN, Stellair Compliant inlet air; for 2006382; see manual 3B0141	1
6	116393	ADAPTER; 1/4 npt (m x f)	1		L40T10	GUN, Pro Xp 40 electrostatic; for 233743	1
7	115219	TEE; 1/4 npt(m)	1		L60T10	GUN, Pro Xp 60 electrostatic; for 233744	1
8	116514	NUT, regulator	2		L85T10	GUN, Pro Xp 85 electrostatic; for 289649	1
9	116513	REGULATOR, air	2	56	116395	ELBOW; cst; 1/4 npt(m) x 3/8 npt(f) swivel; for 233477, 233743, 233744	1
10	162453	NIPPLE; 1/4 npsm x 1/4 npt	1		207123	ELBOW; sst; 3/8 npt(m) x 3/8 npsm(f) swivel; for 233478	1
11	115948	ELBOW; 1/4 npt(m) x 0.312 in. (8 mm) OD tubing	2	57	241976	REGULATOR, fluid; acetal; 0–30 psi (0–0.2 MPa, 0–2 bar) range; includes gauge; for 233477, 233743, 233744; see manual 308325	1
12	buy locally	TUBE; polyethylene; 0.312 in. (8 mm) OD	0.5 ft		214895	REGULATOR, fluid; sst 0–100 psi (0–0.6 MPa, 0–7 bar) range; for 233478; see manual 307212	1
14	114363	VALVE, ball, fluid; sst; 3/8 npt(fbe)	1	58	187874	GAUGE, pressure, fluid; sst; for 233478	1
15	116314	ELBOW; 3/8 npt(m) x 0.25 in. (6 mm) OD tubing	1				
16	buy locally	TUBE; polyethylene; 0.25 in. (6 mm) OD	5.3 ft				
22	197449	SPACER	4				
23	218798	STRAINER	1				
30	110436	GAUGE, pressure, air	2				
31	218743	FRAME, stand, pump	1				
32	108175	PLUG, stand	4				
33	100333	SCREW, cap, hex hd; 1/4–20 x 0.5 in. (13 mm)	4				
39	104034	WASHER; 5/16 size	2				
40	111040	NUT, lock; nylon insert; 5/16–18	2				
45	113786	TEE; cst; 3/8 npt(m); for 233473, 233475, 233477, 233743, 233744	1				
	116400	TEE; sst; 3/8 npt(m); for 233474, 233476, 233478, 2006382	1				
46	244432	HOSE, suction; aluminum and LDPE; for 233473, 233475, 233477	1				
	244433	HOSE, suction; sst; for 233474, 233476, 233478, 233479, and 2006382	1				
47	116350	BUSHING; sst; 3/4 npt(m) x 3/8 npt(f)	1				

Ref.	Part	Description	Qty
59	165198	NIPPLE; cst; 1/4 npt x 3/8 npt; <i>for 233477, 233743, 233744</i>	1
	171195	NIPPLE; sst; 3/8 npsm x 3/8 npt; <i>for 233478</i>	1
60	233499	HOSE ASSY; sst fittings; 3/8 npsm(f) nylon fluid hose; 1/4 npsm(f) air hose; 25 ft (7.6 m); <i>for 233476, 233478, 233475, 233477</i>	1
	240425	HOSE ASSY, electrostatic; 3/8 npsm(f) nylon fluid hose; 1/4 npsm(f) air hose with ground wire and left-hand thread; 25 ft (7.6 m); <i>for 233743, 233744, 289649</i>	1
	2006234	HOSE ASSY, NO-QC; 3/8 npsm(f) LLDPE fluid hose; 1/4 npsm(f) air hose; 25 ft (7.6 m); <i>for 2334476, 233478, 233475, 233477, 234913, 234914</i>	1
	2006235	HOSE ASSY, QC; 3/8 npsm(f) x 1/8 npsm(f) LL DPE fluid hose; 1/4 npsm(f) air hose; 25 ft (11.6 m); <i>for 2006382</i>	1

Cart Mount Packages (see Models, page 3)

Models 233480, 233481, 233482, 233483, 233484, 233485, 234915, 234916, 233746, 233747, 289634, 289635, 289636, 289638, 289639, 289640, 289641, and 2006383

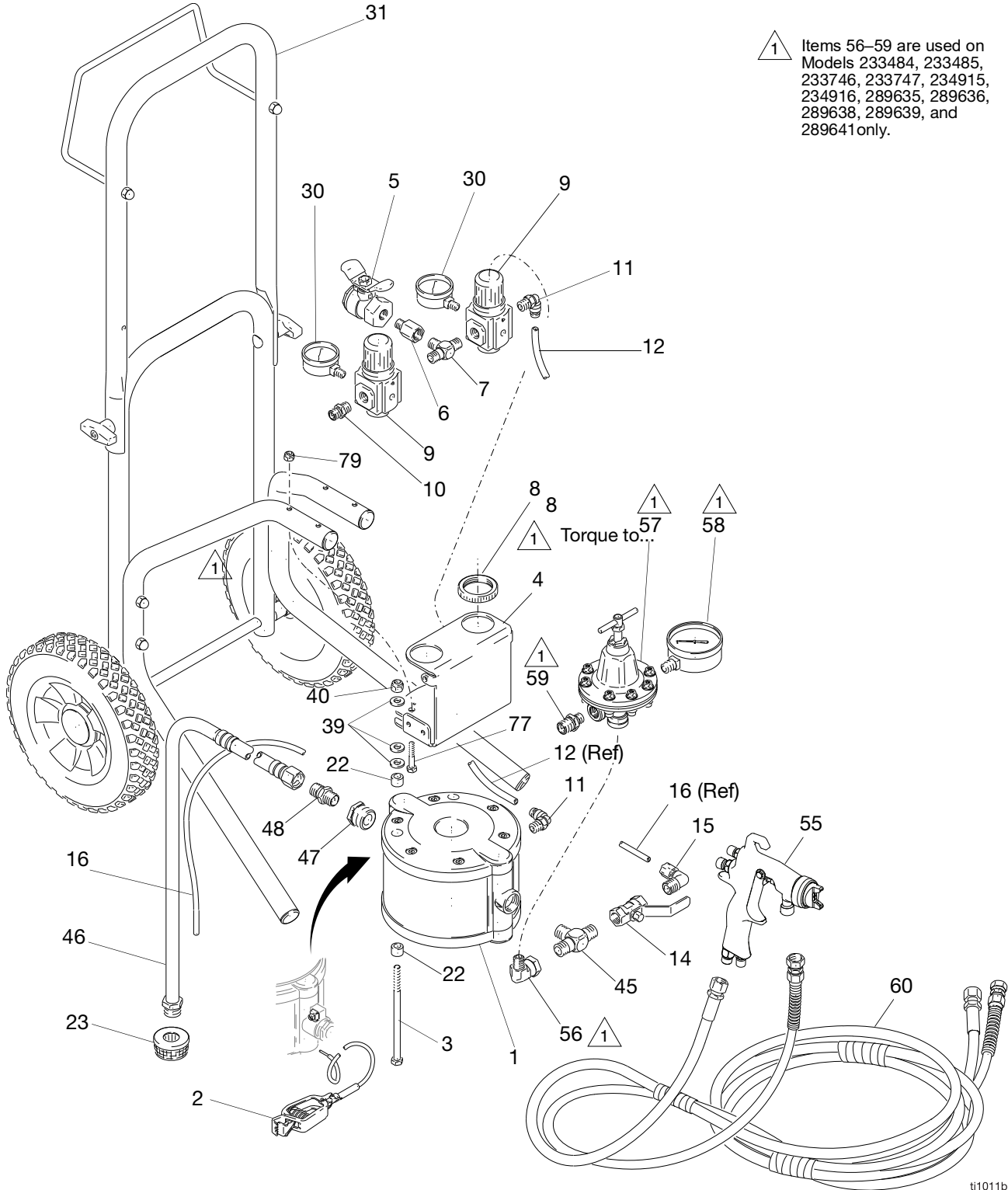

t1011b

Cart Mount Packages

Ref.	Part	Description	Qty	Ref.	Part	Description	Qty
1	233500	PUMP, diaphragm; aluminum; <i>for 233480, 233482, 233484, 233746, 233747</i>	1	55	L40T10	GUN, Pro Xp 40 electrostatic; <i>for 233746</i>	1
	233501	PUMP, diaphragm; sst; <i>for 233481, 233483, 233485, and 2006383</i>	1		L60T10	GUN, Pro Xp 60 electrostatic; <i>for 233747</i>	1
2	238909	GROUND WIRE & CLAMP ASSY	1		L85T10	GUN, Pro Xp 85 electrostatic; <i>for 289641</i>	1
3	116311	SCREW, cap, hex hd; 5/16 unc x 5.5 in. (140 mm)	2	2004145	GUN, Stellair Conventional; <i>for 233482, 233483; see manual 3B0141</i>	1	
4	197126	BRACKET, control	1	2004152	GUN, Stellair HVLP spray; <i>for 233484, 233485; see manual 3B0141</i>	1	
5	116473	VALVE, air, bleed-type; 1/4 npt(fbe)	1	2004155	GUN, Stellair Compliant spray; <i>for 234915, 234916; see manual 3B0141</i>	1	
6	116393	ADAPTER; 1/4 npt (m x f)	2	2005972	GUN, Stellair Compliant inlet air; <i>for 2006383; see manual 3B0141</i>	1	
7	115219	TEE; 1/4 npt(m)	1	56	116395	ELBOW; cst; 1/4 npt(m) x 3/8 npt(f) swivel; <i>for 233484, 233746, 233747</i>	1
8	116514	NUT, regulator	2		207123	ELBOW; sst; 3/8 npt(m) x 3/8 npsm(f) swivel; <i>for 233485</i>	1
9	116513	REGULATOR, air	2	57	241976	REGULATOR, fluid; acetal; 0–30 psi (0–0.2 MPa, 0–2 bar) range; includes gauge; <i>for 233484, 233746, 233747; see manual 308325</i>	1
10	162453	NIPPLE; 1/4 npsm x 1/4 npt	1		214895	REGULATOR, fluid; sst 0–100 psi (0–0.6 MPa, 0–7 bar) range; <i>for 233485; see manual 307212</i>	1
11	115948	ELBOW; 1/4 npt(m) x 0.312 in. (8 mm) OD tubing	2	58	187874	GAUGE, pressure, fluid; sst; <i>for 233485</i>	1
12	buy locally	TUBE; polyethylene; 0.312 in. (8 mm) OD	0.5 ft	59	165198	NIPPLE; cst; 1/4 npt x 3/8 npt; <i>for 233491, 233748, 233749</i>	1
14	114363	VALVE, ball, fluid; sst; 3/8 npt(fbe)	1		171195	NIPPLE; sst; 3/8 npsm x 3/8 npt; <i>for 233492</i>	1
15	116314	ELBOW; 3/8 npt(m) x 0.25 in. (6 mm) OD tubing	1				
16	buy locally	TUBE; polyethylene; 0.25 in. (6 mm) OD	5.3 ft				
22	197449	SPACER	4				
23	218798	STRAINER	1				
30	110436	GAUGE, pressure, air	2				
31	233581	CART ASSEMBLY	1				
39	104034	WASHER; 5/16 size	6				
40	111040	NUT, lock; nylon insert; 5/16–18	2				
45	113786	TEE; cst; 3/8 npt(m); <i>for 233480, 233482, 233484, 233746, 233747</i>	1				
	116400	TEE; sst; 3/8 npt(m); <i>for 233481, 233483, 233485, 2006383</i>	1				
46	244432	HOSE, suction; aluminum and LDPE; <i>for 233480, 233482, 233484, 233746, 233747</i>	1				
	244433	HOSE, suction; sst; <i>for 233481, 233483, 233485, and 2006383</i>	1				
47	116350	BUSHING; sst; 3/4 npt(m) x 3/8 npt(f)	1				
48	162485	NIPPLE; cst; 3/8 npsm x 3/8 npt; <i>for 233480, 233482, 233484, 233746, 233747</i>	1				
	112100	NIPPLE; sst; 9/16–18 x 3/8 npt; <i>for 233481, 233483, 233485, 2006383</i>	1				

Parts

Ref.	Part	Description	Qty
60	233499	HOSE ASSY; sst fittings; 3/8 npsm(f) nylon fluid hose; 1/4 npsm(f) air hose; 25 ft (7.6 m); <i>for 289634, 289635, 289636, 289638, 289639, 289640</i>	1
	240425	HOSE ASSY, electrostatic; 3/8 npsm(f) nylon fluid hose; 1/4 npsm(f) air hose with ground wire and left-hand thread; 25 ft (7.6 m); <i>for 233746, 233747, 289641</i>	1
	2006234	HOSE ASSY, NO-QC; 3/8 npsm(f) LLDPE fluid hose; 1/4 npsm(f) air hose; 25 ft (7.6 m); <i>for 233489, 233490, 233491, 233492, 234917, 234918</i>	1
	2006235	HOSE ASSY, QC; 3/8 npsm(f) x 1/8 npsm(f) LL DPE fluid hose; 1/4 npsm(f) air hose; 25 ft (11.6 m); <i>for 2006383</i>	1
77	100058	SCREW, cap, hex hd; 1/4-20 x 1.5 in. (38 mm)	4
79	102040	NUT, lock; nylon insert; 1/4-20	4

Wall Mount Packages (see Models, page 3)

Models 233487, 233488, 233489, 233490, 233491, 233492, 234917, 234918, 233748, 233749, 289622, 289623, 289624, 289625, 289626, 289627, 289628, 289629, 289630, 289631, and 2008001

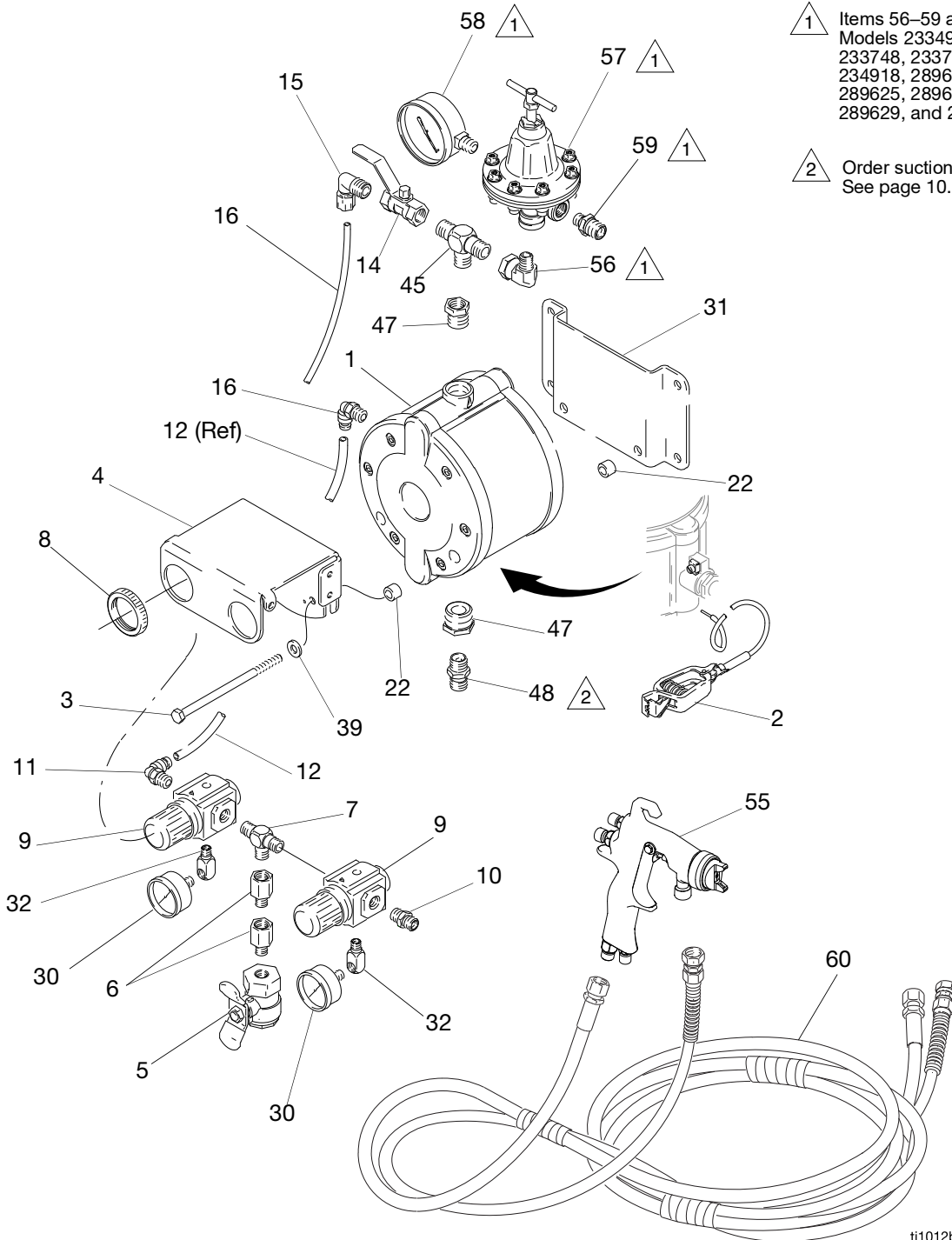

1 Items 56–59 are used on Models 233491, 233492, 233748, 233749, 234917, 234918, 289622, 289623, 289625, 289626, 289628, 289629, and 289631 only.

2 Order suction kits separately. See page 10.

ti1012b

Wall Mount Packages

Ref.	Part	Description	Qty	Ref.	Part	Description	Qty
1	233500	PUMP, diaphragm; aluminum; for 233487, 233489, 233491, 233748, and 233749	1	55		For guns L40T10, L60T10, and L85T10 see manual 3A2494	
	233501	PUMP, diaphragm; sst; for 233488, 233490, 233492, and 2008001	1		L40T10	GUN, Pro Xp 40 electrostatic; for 233748	1
2	238909	GROUND WIRE & CLAMP ASSY	1		L60T10	GUN, Pro Xp 60 electrostatic; for 233749	1
3	116311	SCREW, cap, hex hd; 5/16 unc x 5.5 in. (140 mm)	2		L85T10	GUN, Pro Xp 85 electrostatic; for 289631	1
4	197126	BRACKET, control	1	2004145		GUN, Stellair conventional; for 233489, 233490; see manual 3B0141	1
5	116473	VALVE, air, bleed-type; 1/4 npt(fbe)	1	2004152		GUN, Stellair HVLP spray; for 233491, 233492; see manual 3B0141	1
6	116393	ADAPTER; 1/4 npt (m x f)	2	2004155		GUN, Stellaircomplantspray; for 234917, 233918; see manual 3B0141	1
7	115219	TEE; 1/4 npt(m)	1	56	116395	ELBOW; cst; 1/4 npt(m) x 3/8 npt(f) swivel; for 233491, 233748, 233749	1
8	116514	NUT, regulator	2		207123	ELBOW; sst; 3/8 npt(m) x 3/8 npsm(f) swivel; for 233492	1
9	116513	REGULATOR, air	2	57	241976	REGULATOR, fluid; acetal; 0–30 psi (0–0.2 MPa, 0–2 bar) range; includes gauge; for 233491, 233748, 233749; see manual 308325	1
10	162453	NIPPLE; 1/4 npsm x 1/4 npt	1		214895	REGULATOR, fluid; sst 0–100 psi (0–0.6 MPa, 0–7 bar) range; for 233492; see manual 307212	1
11	115948	ELBOW; 1/4 npt(m) x 0.312 in. (8 mm) OD tubing	2	58	187874	GAUGE, pressure, fluid; sst; for 233492	1
12	buy locally	TUBE; polyethylene; 0.312 in. (8 mm) OD	0.5 ft				
14	114363	VALVE, ball, fluid; sst; 3/8 npt(fbe)	1				
15	116314	ELBOW; 3/8 npt(m) x 0.25 in. (6 mm) OD tubing	1				
16	buy locally	TUBE; polyethylene; 0.25 in. (6 mm) OD	6.3 ft				
22	197449	SPACER	4				
30	108190	GAUGE, pressure, air	2				
31	197426	BRACKET, wall mount	1				
32	191892	FITTING, elbow, street; 90	2				
39	104034	WASHER; 5/16 size	2				
45	113786	TEE; cst; 3/8 npt(m); for 233487, 233489, 233491, 233748, 233749	1				
	116400	TEE; sst; 3/8 npt(m); for 233488, 233490, 233492, and 2008001	1				
47	116350	BUSHING; sst; 3/4 npt(m) x 3/8 npt(f)	1				
48	162485	NIPPLE; cst; 3/8 npsm x 3/8 npt; for 233487, 233489, 233491, 233748, 233479	1				
	112100	NIPPLE; sst; 9/16–18 x 3/8 npt; for 233488, 233490, 233492, and 2008001	1				

Ref.	Part	Description	Qty
59	165198	NIPPLE; cst; 1/4 npt x 3/8 npt; <i>for</i> 233491, 233748, 233749	1
	171195	NIPPLE; sst; 3/8 npsm x 3/8 npt; <i>for</i> 233492	1
60	233499	HOSE ASSY; sst fittings; 3/8 npsm(f) nylon fluid hose; 1/4 npsm(f) air hose; 25 ft (7.6 m); <i>for</i> 289622, 289623, 289624, 289625, 289626, 289627, 289628, 289629, 289630	1
	240425	HOSE ASSY, electrostatic; 3/8 npsm(f) nylon fluid hose; 1/4 npsm(f) air hose with ground wire and left-hand thread; 25 ft (7.6 m); <i>for</i> 233748, 233749, and 289631	1
	2006234	HOSE ASSY, NO-QC, 3/8 npsm(f) LLDPE fluid hose; 1/4 npsm(f) air hose; 25 ft (7.6 m); <i>for</i> 233489, 233490, 233491, 233492, 234917, 234918	1
	2006235	HOSE ASSY, QC; 3/8 npsm(f) hose bundle; 25 ft (7.6 m); <i>for</i> 2008001	1

Technical Specifications

Triton 1:1 Spray Packages		
	US	Metric
Maximum fluid working pressure	100 psi	0.7 MPa, 7 bar
Maximum incoming air pressure	100 psi	0.7 MPa, 7 bar
Maximum operating temperature	120°	49°C
Materials of Construction		
Pump	See TRITON™ 1:1 Diaphragm Pump, Instructions-Parts manual. See Related Manuals , page 2.	
Gun	See gun instruction manual. See Related Manuals , page 2.	
Fluid pressure regulator	See regulator instruction manual. See Related Manuals , page 2.	
Fluid hoses, aluminum packages	nylon, nickel-plated carbon steel (cst), LDPE/rubber blend (suction hose), aluminum	
Fluid hoses, stainless steel packages	nylon, stainless steel (sst), LDPE/rubber blend (suction hose)	
Fluid hoses, electrostatic packages	nylon, nickel-chrome plated carbon steel (cst), LDPE/rubber blend (suction hose)	
Fluid fittings, aluminum packages	Zinc-plated carbon steel (cst), stainless steel (sst), polypropylene, polyethylene	
Fluid fittings, stainless steel packages	Stainless steel (sst), polypropylene, polyethylene	
Pail cover, aluminum packages	Zinc-plated carbon steel (cst)	
Pail cover, stainless steel packages	Stainless steel (sst)	
Weight (without hoses or gun)		
Pail mount packages (Aluminum)	22 lb.	10 kg
Pail mount packages (Stainless Steel)	28 lb.	12.7 kg
Stand mount packages (Aluminum)	20 lb.	9.1 kg
Stand mount packages (Stainless Steel)	27 lb.	12.3 kg
Cart mount packages (Aluminum)	30 lb.	13.6 kg
Cart mount packages (Stainless Steel)	36 lb.	16.4 kg
Wall mount packages (Aluminum)	19 lb.	8.6 kg
Wall mount packages (Stainless Steel)	24 lb.	10.9 kg

Sound Pressure Levels in dB(A)* (measured at 1 m from unit)

Input Air Pressures	Sound Pressure
Pump: 20 psi (0.14 MPa, 1.4 bar), Fluid Regulator: 5 psi (0.035 MPa, 0.35 bar)	64.7
Pump: 40 psi (0.28 MPa, 2.8 bar), Fluid Regulator: 15 psi (0.105 MPa, 1.05 bar)	68.5
Pump: 40 psi (0.28 MPa, 2.8 bar), No Fluid Regulator	69.1
Pump: 40 psi (0.28 MPa, 2.8 bar), Circulation Mode	69.2
Pump: 60 psi (0.42 MPa, 4.2 bar), No Fluid Regulator	72.1

Sound Pressure Levels in dB(A)* (tested in accordance with ISO 3744)

Input Air Pressures	Sound Pressure
Pump: 20 psi (0.14 MPa, 1.4 bar), Fluid Regulator: 5 psi (0.035 MPa, 0.35 bar)	76.3
Pump: 40 psi (0.28 MPa, 2.8 bar), Fluid Regulator: 15 psi (0.105 MPa, 1.05 bar)	80.1
Pump: 40 psi (0.28 MPa, 2.8 bar), No Fluid Regulator	80.8
Pump: 40 psi (0.28 MPa, 2.8 bar), Circulation Mode	80.8
Pump: 60 psi (0.42 MPa, 4.2 bar), No Fluid Regulator	83.7

* Sound readings are for bare packages only. Refer to the separate gun manuals for gun sound data.

California Proposition 65

CALIFORNIA RESIDENTS

 **WARNING:** Cancer and reproductive harm – www.P65warnings.ca.gov.

Wall Mounting Template

Use this drawing as a template to drill mounting holes in the wall. Verify that the dimensions are exact and the hole locations are level before drilling the holes.

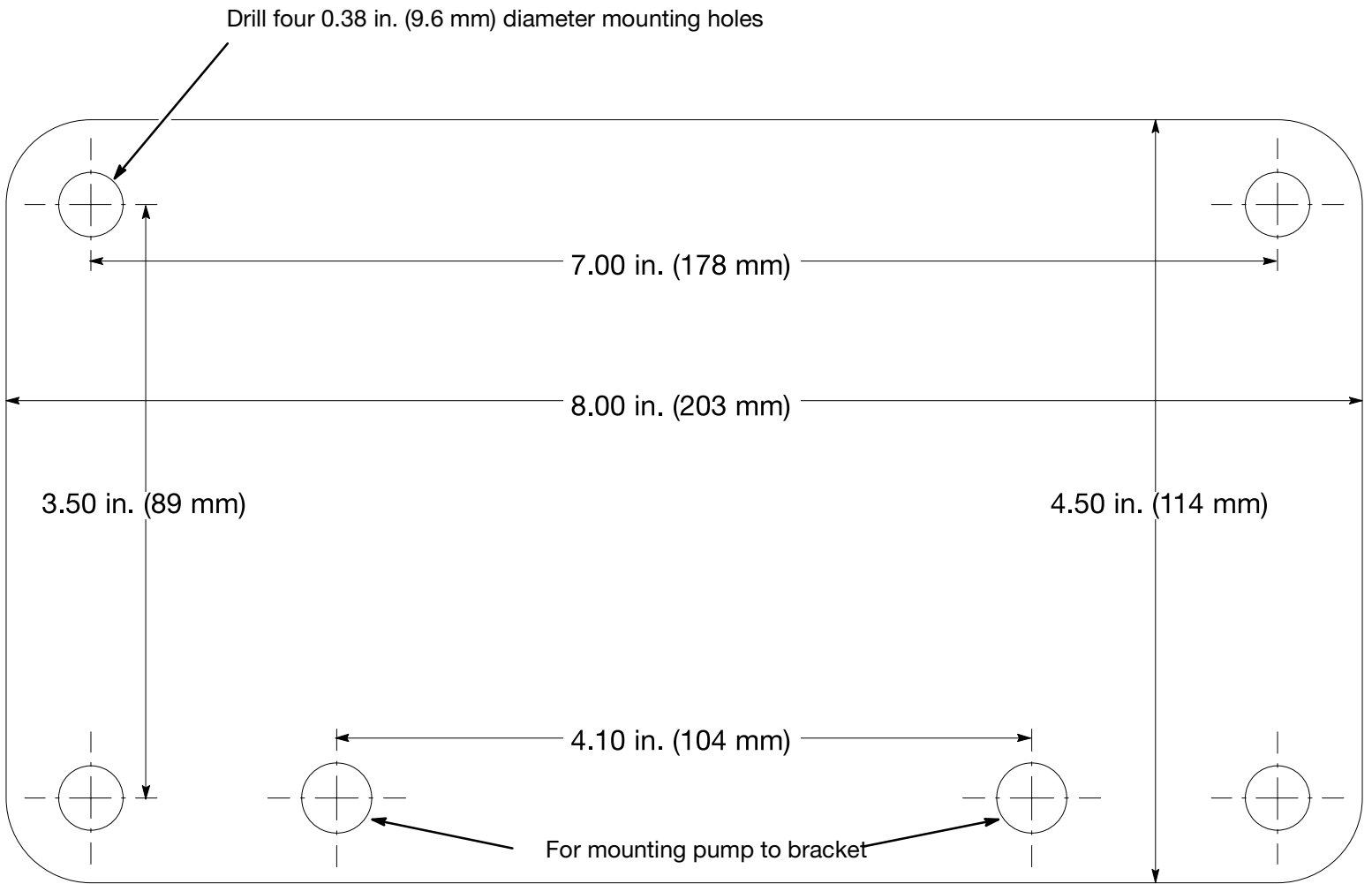

ti02657a

Graco Standard Warranty

Graco warrants all equipment referenced in this document which is manufactured by Graco and bearing its name to be free from defects in material and workmanship on the date of sale to the original purchaser for use. With the exception of any special, extended, or limited warranty published by Graco, Graco will, for a period of twelve months from the date of sale, repair or replace any part of the equipment determined by Graco to be defective. This warranty applies only when the equipment is installed, operated and maintained in accordance with Graco's written recommendations.

This warranty does not cover, and Graco shall not be liable for general wear and tear, or any malfunction, damage or wear caused by faulty installation, misapplication, abrasion, corrosion, inadequate or improper maintenance, negligence, accident, tampering, or substitution of non-Graco component parts. Nor shall Graco be liable for malfunction, damage or wear caused by the incompatibility of Graco equipment with structures, accessories, equipment or materials not supplied by Graco, or the improper design, manufacture, installation, operation or maintenance of structures, accessories, equipment or materials not supplied by Graco.

This warranty is conditioned upon the prepaid return of the equipment claimed to be defective to an authorized Graco distributor for verification of the claimed defect. If the claimed defect is verified, Graco will repair or replace free of charge any defective parts. The equipment will be returned to the original purchaser transportation prepaid. If inspection of the equipment does not disclose any defect in material or workmanship, repairs will be made at a reasonable charge, which charges may include the costs of parts, labor, and transportation.

THIS WARRANTY IS EXCLUSIVE, AND IS IN LIEU OF ANY OTHER WARRANTIES, EXPRESS OR IMPLIED, INCLUDING BUT NOT LIMITED TO WARRANTY OF MERCHANTABILITY OR WARRANTY OF FITNESS FOR A PARTICULAR PURPOSE.

Graco's sole obligation and buyer's sole remedy for any breach of warranty shall be as set forth above. The buyer agrees that no other remedy (including, but not limited to, incidental or consequential damages for lost profits, lost sales, injury to person or property, or any other incidental or consequential loss) shall be available. Any action for breach of warranty must be brought within two (2) years of the date of sale.

GRACO MAKES NO WARRANTY, AND DISCLAIMS ALL IMPLIED WARRANTIES OF MERCHANTABILITY AND FITNESS FOR A PARTICULAR PURPOSE, IN CONNECTION WITH ACCESSORIES, EQUIPMENT, MATERIALS OR COMPONENTS SOLD BUT NOT MANUFACTURED BY GRACO. These items sold, but not manufactured by Graco (such as electric motors, switches, hose, etc.), are subject to the warranty, if any, of their manufacturer. Graco will provide purchaser with reasonable assistance in making any claim for breach of these warranties.

In no event will Graco be liable for indirect, incidental, special or consequential damages resulting from Graco supplying equipment hereunder, or the furnishing, performance, or use of any products or other goods sold hereto, whether due to a breach of contract, breach of warranty, the negligence of Graco, or otherwise.

FOR GRACO CANADA CUSTOMERS

The Parties acknowledge that they have required that the present document, as well as all documents, notices and legal proceedings entered into, given or instituted pursuant hereto or relating directly or indirectly hereto, be drawn up in English. Les parties reconnaissent avoir convenu que la rédaction du présente document sera en Anglais, ainsi que tous documents, avis et procédures judiciaires exécutés, donnés ou intentés, à la suite de ou en rapport, directement ou indirectement, avec les procédures concernées.

Graco Information

For the latest information about Graco products, visit www.graco.com.

For patent information, see www.graco.com/patents.

TO PLACE AN ORDER, contact your Graco distributor or call to identify the nearest distributor.

Toll Free Phone Number: 1-800-328-0211

All written and visual data contained in this document reflects the latest product information available at the time of publication. Graco reserves the right to make changes at any time without notice.

Original instructions. This manual contains English. MM 309304

Graco Headquarters: Minneapolis

International Offices: Belgium, China, Japan, Korea

GRACO INC. AND SUBSIDIARIES • P.O. BOX 1441 • MINNEAPOLIS MN 55440-1441 • USA
Copyright 2001, Graco Inc. All Graco manufacturing locations are registered to ISO 9001.

www.graco.com
Revision S, July 2024